

SUBMITTAL INFORMATION

Ductile Iron Transition Coupling - (FC2A-xxxx-xxxx-ESH style)

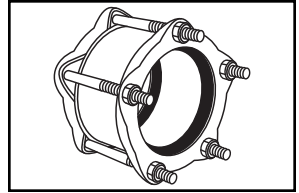

10" & 12" STYLE FC2A COUPLINGS FOR JOINING PIPES WITH THE SAME OR DIFFERENT O.D.'S

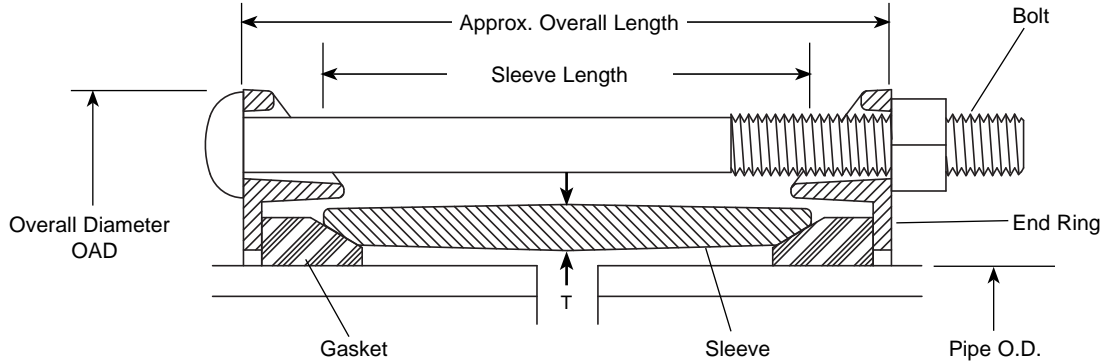

| NOM. PIPE SIZE | GASKET RANGE | | END RING COLOR | BY | GASKET RANGE | | END RING COLOR | CENTER SLEEVE | | BOLTS | | APPROX. OVERALL LGTH. | OAD | APPROX. WT. LBS. | CATALOG NUMBER | ✓ SUBMITTED ITEM(S) |
|----------------|-----------------|-----------------|----------------|----|-----------------|-----------------|--------------------|---------------|-----------------------|-------|-------|-----------------------|--------|------------------|----------------|---------------------|
| | 1ST HALF CAT. # | 2ND HALF CAT. # | | | 1ST HALF CAT. # | 2ND HALF CAT. # | | LGTH. | APPROX. (T) THICKNESS | DIA. | LGTH. | | | | | |
| 10" | 10.75 | 10.75 | Red | X | 10.75 | 10.75 | Red | 6" | 7/16" | 5/8" | 9" | 6 | 7-1/8" | 15-11/16" | 48 | FC2A-1075-1075-ESH |
| | 10.75 | 11.10 - 11.40 | Red | | 11.10 - 11.40 | Blk | FC2A-1075-1140-ESH | | | | | | | | | |
| | 10.75 | 11.42 - 11.77 | Red | | 11.42 - 11.77 | Blk | FC2A-1075-1177-ESH | | | | | | | | | |
| | 10.75 | 11.77 - 12.12 | Red | | 11.77 - 12.12 | Wht/Gry | FC2A-1075-1212-ESH | | | | | | | | | |
| | 11.10 - 11.40 | 11.10 - 11.40 | Blk | | 11.10 - 11.40 | Blk | FC2A-1140-1140-ESH | | | | | | | | | |
| | 11.10 - 11.40 | 11.42 - 11.77 | Blk | | 11.42 - 11.77 | Blk | FC2A-1140-1177-ESH | | | | | | | | | |
| | 11.10 - 11.40 | 11.77 - 12.12 | Blk | | 11.77 - 12.12 | Wht/Gry | FC2A-1140-1212-ESH | | | | | | | | | |
| | 11.42 - 11.77 | 11.42 - 11.77 | Blk | | 11.42 - 11.77 | Blk | FC2A-1177-1177-ESH | | | | | | | | | |
| | 11.42 - 11.77 | 11.77 - 12.12 | Blk | | 11.77 - 12.12 | Wht/Gry | FC2A-1177-1212-ESH | | | | | | | | | |
| | 11.77 - 12.12 | 11.77 - 12.12 | Wht/Gry | | 11.77 - 12.12 | Wht/Gry | FC2A-1212-1212-ESH | | | | | | | | | |
| 12" | 12.75 | 12.75 | Blk | X | 12.75 | 12.75 | Blk | 6" | 1/2" | 5/8" | 9" | 7" | 7-1/8" | 18" | 56 | FC2A-1275-1275-ESH |
| | 12.75 | 13.20 - 13.50 | Blk | | 13.20 - 13.50 | Blk | FC2A-1275-1350-ESH | | | | | | | | | |
| | 12.75 | 13.69 - 14.04 | Blk | | 13.69 - 14.04 | Wht/Gry | FC2A-1275-1404-ESH | | | | | | | | | |
| | 12.75 | 14.03 - 14.38 | Blk | | 14.03 - 14.38 | Wht/Gry | FC2A-1275-1438-ESH | | | | | | | | | |
| | 13.20 - 13.50 | 13.20 - 13.50 | Blk | | 13.20 - 13.50 | Blk | FC2A-1350-1350-ESH | | | | | | | | | |
| | 13.20 - 13.50 | 13.69 - 14.04 | Blk | | 13.69 - 14.04 | Wht/Gry | FC2A-1350-1404-ESH | | | | | | | | | |
| | 13.20 - 13.50 | 14.03 - 14.38 | Blk | | 14.03 - 14.38 | Wht/Gry | FC2A-1350-1438-ESH | | | | | | | | | |
| | 13.69 - 14.04 | 13.69 - 14.04 | Wht/Gry | | 13.69 - 14.04 | Wht/Gry | FC2A-1404-1404-ESH | | | | | | | | | |
| | 13.69 - 14.04 | 14.03 - 14.38 | Wht/Gry | | 14.03 - 14.38 | Wht/Gry | FC2A-1404-1438-ESH | | | | | | | | | |
| | 14.03 - 14.38 | 14.03 - 14.38 | Wht/Gry | | 14.03 - 14.38 | Wht/Gry | FC2A-1438-1438-ESH | | | | | | | | | |

Note: Flexible Couplings do not restrain axial forces on piping.

FEATURES

- Center Sleeve: Ductile Iron per ASTM A536 (65-45-12)
- End Rings: Ductile Iron per ASTM A536 (65-45-12)
- Bolts and Nuts: 304 Stainless Steel per ASTM A193 and A194
- Coating: Fusion-bonded Epoxy. Applied per AWWA C213
- NSF61: NSF 61 Approved
- Gasket: Molded SBR Rubber per ASTM D2000, M4AA810

The Ford Meter Box Company considers the information in this submittal form to be correct at the time of publication. Item and option availability, including specifications, are subject to change without notice. Please verify that your product information is current.



The Ford Meter Box Company, Inc.

P.O. Box 443, Wabash, Indiana U.S.A. 46992-0443

Phone: 260-563-3171 / Fax: 800-826-3487

Overseas Fax: 260-563-0167

<http://www.fordmeterbox.com>

04/22/09

Submitted By: